

# MXG 638

EXTREME

**Scotsman**  
Ice Systems

## Modular Ice Machine - Volt 230/50 up to 360 kg

Item #:
Project:
Quantity:



### FEATURES

- Individual transparent solid cube: each single cube is an artwork: crystal clear and perfectly shaped, faithful to the Scotsman tradition.
- Global standard footprint: strictly follows international imperial standard commonly adopted in the industry of reference.
- Agion: the technology that makes products cleaner and longer lasting with built-in protection working 24/7 to resist the growth of microbes and the development of unpleasant odors.
- Electronic control: ambient and water temperatures may change throughout the years but your ice will stay the same.
- External indicator lights: keeps ice maker's operations under constant surveillance.
- Front access condenser air filter: a do-it-yourself cleaning operation that saves time and money and makes your ice maker live longer.
- Clean alert: advises with a blink when it's time to clean the filter.



MXG L 638  
Large Gourmet 39 g  
Ø 38 x H 41 mm



MXG M 638  
Medium Gourmet 20 g  
Ø 30 x H 34 mm



MXG S 638  
Small Gourmet 8 g  
Ø 21 x H 25 mm

### CONDENSING SYSTEM

Air cooled  
Remote condenser  
Water cooled

### REFRIGERANT GAS

R404A

### VOLTAGE V/Hz/ph

230/50/1  
230/60/1  
400/50/3N

### RECOMMENDED BINS

Head	Bins	kg
	✓ SB393	181
	✓ SB530	243
	BINTOPMKG55 SB550	252
MXG 638	CBT48EAMCD SB948	406
	CBT52EAMCD SB1025	478
	● UBH1600	812
	● SIS1350	613 + 73 + 73

### LEGENDA:

- ✓ : Perfect combination between ice maker and bin
- : Ice chute cut-out performed upon installation
- CBTxxxxxxx : need additional bin top

Certifications:



### OPERATING REQUIREMENTS

	Minimum	Maximum
Air temperature	10°C	43°C
Water temperature	5°C	38°C
Water pressure	1 bar (14 psi)	5 bar (70 psi)
Electrical voltage	-10%	+10%

**IMPORTANT NOTICE:**  
Models and specifications are subject to change without notice. This spec sheet is meant for commercial purpose only. For technical documentation please refer to our service manuals.

Download our free **App Scotsman Ice**  
Apple store  
Google play  
Windows store



[www.scotsman-ice.it](http://www.scotsman-ice.it)  
[www.scotsman-ice.com](http://www.scotsman-ice.com)

Modular Ice Machine Volt 230/50 - up to 360 kg

# MXG 638

EXTREME

**Scotsman**  
Ice Systems

Modular Ice Machine - Volt 230/50  
up to 360 kg

Item #:  
Project:  
Quantity:

Modular Ice Machine Volt 230/50 - up to 360 kg

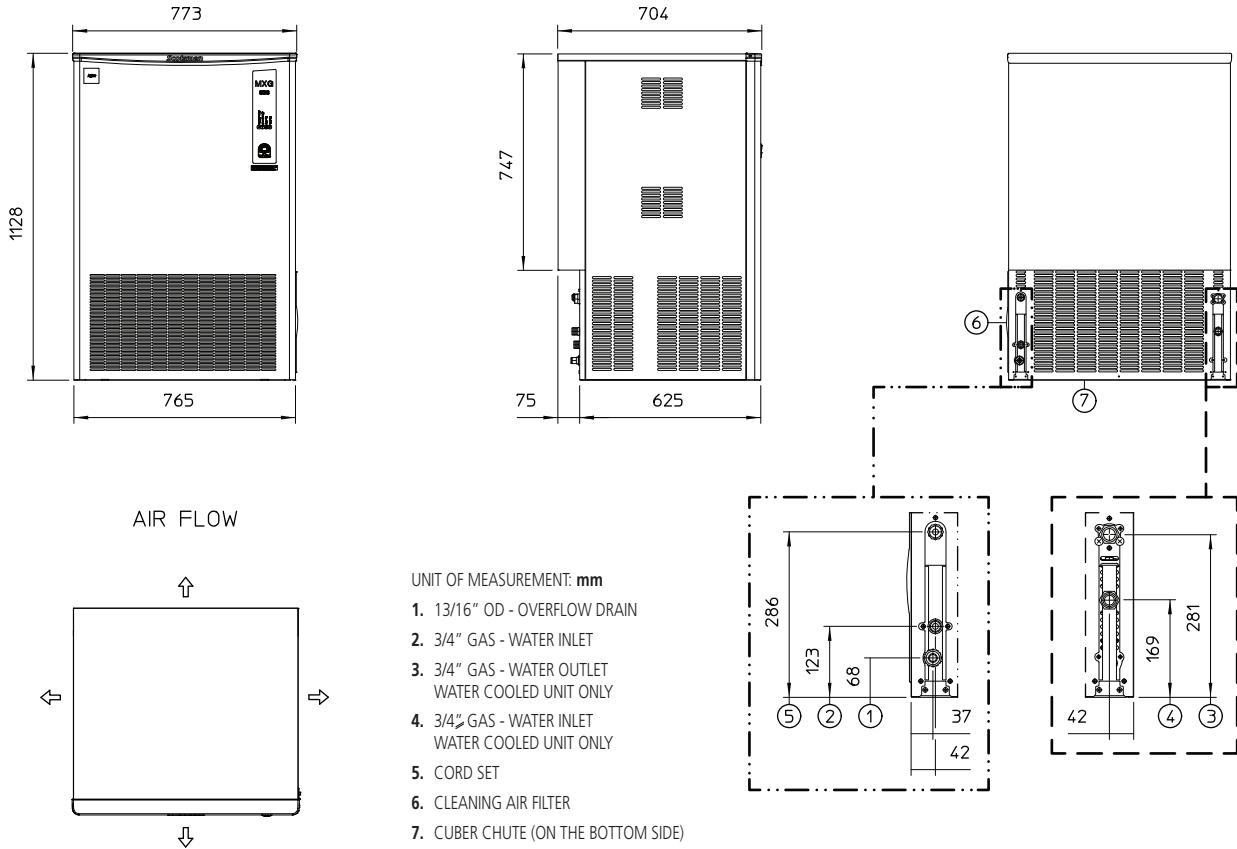

UNIT DATA			Compressor		Circuit wires		Max. fuse size		
			Version	Voltage	Btu/h	W	No.	Ømm <sup>2</sup>	A
Size (W x D x H)	773 x 704 x 1128 mm	MXG L 638 AS	230/50/1	25250	7400	3	2.5	20	
Net weight	116 kg	MXG L 638 WS	230/50/1	25250	7400	3	2.5	20	
<b>SHIPPING DATA</b>	Carton (W x D x H) 830 x 770 x 1320 mm Weight 129 kg	MXG M 638 AS	230/50/1	25250	7400	3	2.5	20	
		MXG M 638 WS	230/50/1	25250	7400	3	2.5	20	
		MXG S 638 AS	230/50/1	25250	7400	3	2.5	20	
		MXG S 638 WS	230/50/1	25250	7400	3	2.5	20	
				24 h ice production kg °C Amb. / °C Water		Energy consumption*		Water usage*	Instant power
		Version	Condensation	Voltage	10°C/10°C	21°C/10°C	32°C/21°C	kWh/100 kg	kWh/24h
MXG L 638 AS	Air	230/50/1	290	285	230	21.5	49.5	27.9	2500
MXG L 638 WS	Water	230/50/1	290	285	250	19.8	45.5	200.0	2100
MXG M 638 AS	Air	230/50/1	330	310	220	23.2	51.0	22.9	2500
MXG M 638 WS	Water	230/50/1	340	325	290	16.6	48.0	225.0	2200
MXG S 638 AS	Air	230/50/1	360	345	240	23.2	55.6	39.2	2800
MXG S 638 WS	Water	230/50/1	340	325	280	18.6	52.0	275.0	2300

(\*) Data refer to 32°C Amb. / 21°C Water temperature conditions